

TD-9442C2-PA

4MP Dual Illumination AI Bullet Network Camera



- H.265+/H265/H.264+/H264/ MJPEG coding
- Max. resolution: 2592 × 1520
- ICR auto switch, true day / night
- 30 ~ 40m IR or white light range
- 3D DNR, true WDR, HLC, BLC, Defog and ROI coding
- 1CH audio input; 1CH audio output
- 1CH built-in speaker; 1CH built-in microphone
- Built-in micro SD card slot, up to 256GB
- DC12V/PoE power supply
- IP66 ingress protection
- Support three streams
- Intelligent analytics
- Blue and red light warning (flashing alternately)
- Support user-defined warning voice import



en.tvt.net.cn

For more information, please visit our website

Shenzhen TVT DIGITAL TECHNOLOGY CO., LTD.

Address: 23rd Floor, Block B4, Building NO.9, Shenzhen Bay
Eco-Technology Park, Nanshan District, Shenzhen, Guangdong
Province, P.R.China

Tel: +86-755-36995888

Web site: <http://en.tvt.net.cn>

Fax: +86-755-33104777

E-mail: overseas@tvt.net.cn

SPECIFICATIONS

Specifications	Model	TD-9442C2-PA
Camera		
Image Sensor	1 / 3" CMOS	
Image Size	2592 × 1520	
Electronic Shutter	1 / 3s ~ 1 / 100000 s	
Iris Type	DC Iris	Fixed Iris
Min. Illumination	0.03lux@F1.6, AGC ON; 0 lux with LED	
Lens	2.8~12mm@F1.4 H.FoV: 96°~32.33°; V.FoV: 53.67°~19.63°; D.FoV: 114.17°~36.33°	2.8 mm@F1.6, H.FoV:96°; V.FoV: 54.5°; D.FoV:113°; 3.6 mm@F1.6, H.FoV: 79.5°; V.FoV:42°; D.FoV:95°
Focus	Motorized	Fixed
Lens Mount	Φ14	M12
Wide Dynamic Range	120dB	
BLC	Yes	
HLC	Yes	
Defog	Yes	
Digital NR	2D/3D DNR	
S/N Ratio	≥50dB	
Angle Adjustment	Pan: 0°~360°; Tilt: 0°~90°; Rotation: 0°~360°	
Image		
Video Compression	Main stream: H.265+ / H.265 / H.264+ / H.264 Sub/Third stream: H.265+ / H.265 / H.264+ / H.264 / MJPEG	
H.264 Compression Standard	Baseline Profile/Main Profile/High Profile	
Resolution	4MP(2592×1520), 2K(2560×1440), 3MP(2304×1296), 1080P(1920×1080), 720P(1280×720), D1, VGA(640×480), CIF, 480 × 240	
Main Stream	4MP/2K/3MP/1080P(60Hz: 1~30fps; 50Hz: 1~25fps) HFR mode: 1080P/720P(60Hz: 1~60fps; 50Hz: 1~50fps)	
Sub Stream	720P/D1/VGA/CIF(60Hz: 1~30fps; 50Hz: 1~25fps)	
Third Stream	D1/VGA/CIF/480×240 (60Hz: 1~30fps; 50Hz: 1~25fps)	
Bit Rate	64 Kbps ~ 8 Mbps	
Bit Rate Type	VBR / CBR	
Audio Compression	G711A / U	
Image Settings	ROI, Saturation, Brightness, Hue, Contrast, Wide Dynamic, Sharpness, Image Flip, Image Mirror, NR, etc. adjustable through client software or web browser	
ROI	Each ROI to be configured separately	
Interfaces		
Network	RJ 45 10M/100M self-adaptive Ethernet port	
Video Output	No	
Audio	1CH audio input; 1CH audio output; 1CH built-in speaker; 1CH built-in microphone	
Alarm	1CH alarm input; 1CH alarm output	
Storage	Built-in micro SD card slot; up to 256GB	
Reset	Yes	
Functions		
Remote Monitoring	Web Client/NVR/NVMS2.0/Mobile APP	
Web Browser	IE11 (plug-in required)/Chrome 89.0+/Edge 89.0+/Firefox 87.0+/Safari 14.0+	
Online Connection	Support simultaneous monitoring for up to 10 users; Support multi-stream real time transmission	
Network Protocol	UDP, IPv4, IPv6, DHCP, NTP, RTSP, RTP, RTCP, PPPoE, DDNS, SMTP, FTP, SNMP, RTMP, HTTP, 802.1x, UPnP, HTTPS, QoS	
Interface Protocol	ONVIF	
Storage	Network remote storage; micro SD card storage	
Smart Alarm	Motion detection, sensor alarm, SD card error, SD card full, IP address conflict, Cable connection	
General Function	Watermark, IP address filtering, video mask, heartbeat, password protection, image distortion correction	
Security	Video encryption, firmware encryption, HTTPS encryption, configuration encryption, illegal login lock, IP address filtering, 802.1x authentication, basic and digest authentication for HTTP/HTTPS	
PoE	Yes, IEEE802.3af	
Supplement light Range	IR range: 30 ~ 40 m White light range: 30 ~ 40 m	

Protection Grade	IP66			
Intelligent Analytics				
Video Abnormality	Scene change detection, video blur detection, video cast detection			
Perimeter Detection	Line crossing detection (human/vehicle classification); Region intrusion/entrance/exiting detection (human/vehicle classification)			
Sound&Light Warning	Yes			
Other Events	Face detection and face capture, abandoned/missing object detection; heat map; target counting, crowd density detection			
DORI Distance				
Lens	Detect	Observe	Recognize	Identify
2.8mm	59.66m(195.73ft)	23.86m(78.28ft)	11.93m(39.14ft)	5.96m(19.55ft)
3.6mm	79.19m(259.80ft)	31.67m(103.90ft)	15.83m(51.93ft)	7.91m(25.95ft)
2.8~12mm(W)	60.09m(197.14ft)	24.03m(78.83ft)	12.01m(39.40ft)	6.00m(19.68ft)
2.8~12mm(T)	175.72m(576.50ft)	70.28m(230.57ft)	35.14m(115.28ft)	17.57m(57.64ft)
Others				
Power Supply	DC12V/PoE			
Power Consumption	< 12W			
Storage Conditions	- 30 °C ~ 65 °C (-22 °F ~ 149 °F), Humidity: less than 95 % (non-condensing)			
Operating Conditions	- 30 °C ~ 60 °C (-22 °F ~ 140 °F), Humidity: less than 95 % (non-condensing)			
Dimensions (mm)	217.7 × 80.5 × 80.3			
Weight (net)	Approx. 0.68KG			
Installation	Ceiling mounting; wall mounting			
Certificate	CE, FCC			
Environmental Protection	Complies with Directive EU RoHS, WEEE(2012/19/EU), directive 94/62/EC and REACH(EC1907/2006)			

DIMENSIONS

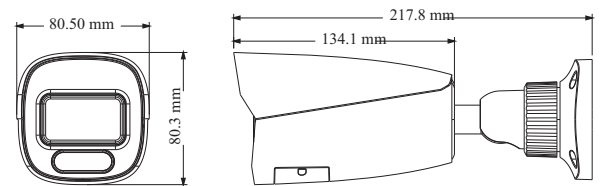

AVAILABLE ACCESSORIES



AVAILABLE MODEL

Available Model	TD-9442C2-PA(D/AZ/PE/AW3)	Motorized lens
	TD-9442C2-PA(D/PE/AW3)	Fixed lens