

Palm-sized 4MP 3X IR Dome PTZ Camera

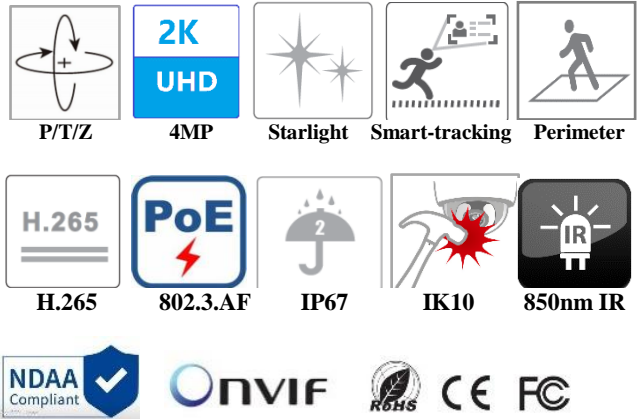

TD-8140IEN(PE/03M/AR2)



Introduction:

TD-8140IEN could output max 2688x1520@30fps ultra HD stream over a middle scene. With the 3x optical lens, it could replace the 2.8mm, 4mm, 6mm and 8mm lens models by one, reducing SKU. The PTZ camera has a tiny gimbal which supports preset and cruise function. Installers and customers could adjust to best view angle and best view distance by remote control, without disassembly of lens dome cover and avoid fingerprints and wall dusts.

The PTZ has built-in 1.5Tops AI engine, which supports multiple faces, human and bi-wheels vehicles detection, classification, capture, and smart tracking. In a typical dim scene, upon detecting of illegal intrusion, the camera will trace moving object, zoom fit in the center screen, triggering snap and recording details until the object leave out of the perimeter area or time expired.

The H.265 encoder could reduce video bandwidth to 50% of H.264 without loss of image details. The PTZ conforms to the ONVIF specifications ensuring interoperability between network video products regardless of manufacturers, and also complies with latest network safety and data protection issue such as GDPR, NDA 2019, PSTI.

The PTZ adopts hidden IR and ultra slim design, especially suited for in-ceiling mounting. With allium alloy and polycarbonate bubble it could suffer IK10 vandalism impact and IP67 water immersion, and could also work in outdoor weather.

Key Spec:

- Up to 2688x1520 resolution
- Mini illumination:
Color: 0.02 lux @ (F1.6 AGC ON)
- 3X optical zoom, fast and accurate
- Pan 80 %S , Tilt80 %S
- Smart IR
- Built-in Mics
- Smart H.265+/H.265/H.264+/H.264
- AI-based face, human, vehicle detection and recognition
- Smart-tracking, perimeter precaution, line crossing, etc.
- Micro SD card chamber, Reset button, Alarm in/out
- PoE and DC12V power supply, easy connection
- IP67, IK10
- ONVIF, API, SDK, IE/NVR/VMS/free mobile Apps

Application:

With ultra slim design and good image quality and protection, this PTZ camera could meet the demand of small size of video surveillance, which is suitable for luxury and retail shop, small office, coffee bar, apartment, etc.

Suggest installation height: 3m to 4m in height.

SPECIFICATION:

| Camera Module | | | | | |
|----------------------|---|-----------------|-----------------|--------------------|-------------------|
| Image sensor | 1/2.7" progressive scan CMOS with BSI and NIR+ technology | | | | |
| Max Resolution | 2688x1520(4.08MP) | | | | |
| Mini. Illumination | Color:0.02 Lux @ (F1.6,AGC ON); B/W: 0.004 Lux @ (F1.6, AGC ON); 0 Lux with IR | | | | |
| Image setting | Saturation, Brightness, Contrast, Sharpness, AGC, and AWB adjusted by client | | | | |
| Shutter Speed | 50Hz: 1/25s~1/25,000s, 60Hz: 1/30s~1/30,000s | | | | |
| White Balance | Auto/Manual/Indoor/Outdoor | | | | |
| Gain | Auto/Manual | | | | |
| Day & Night | Auto/Manual | | | | |
| Aperture control | N/A | | | | |
| S/N Ratio | ≥52dB | | | | |
| 3D DNR | Auto/Manual | | | | |
| AE Enhancement | BLC, HLC, DWDR(suggest in still mode) | | | | |
| Digital Zoom | 8X | | | | |
| Privacy Mask | 4 Programmable privacy masks | | | | |
| Picture overlay | Logo picture could be overlaid on video with 128x128pixels,24bits JPG format | | | | |
| Font overlay | Max 15characters per line, 8lines max, white color or red color | | | | |
| OSD | Time, Date, Device Name, Zoom ratio, Direction(N/S/E/W),PTZ Status, etc. | | | | |
| Lens | | | | | |
| Focus length | f=3.18mm~7.42mm(wide-tele) ±5%, about 3x optical zoom AF lens | | | | |
| Zoom Speed | 1 second(Wide->tele) | | | | |
| Field of View | Horizontal: 113.6 °(W)-44.3 °(T); Vertical :59.6 °(W)-24.9 °(T) ; Diagonal:137.4 °(W)-50.8 °(T); ±5% | | | | |
| Mini View Distance | 40cm | | | | |
| Aperture Range | F1.6 ~ F2.7 (wide-tele) ±10% | | | | |
| IR Cut filter | Switchable ICR | | | | |
| DORI table | Lens | Detect(25px/m) | Observe(63px/m) | Recognize(125px/m) | Identify(250px/m) |
| | f=3.18mm | 62.8m(206 f.t) | 24.9m(81.7 f.t) | 12.56m(41.2f.t) | 6.28m(20.6 f.t) |
| | f=7.42mm | 148.4m(487 f.t) | 58.89m(193 f.t) | 29.68m (97.4 f.t) | 14.84m(48.7f.t) |
| PTZ | | | | | |
| Pan Range | 0~355 ° | | | | |
| Pan speed | Configurable, from 0.5~80 %; Preset speed: 80 %s | | | | |
| Tilt Range | From 15 °to 90 °(auto flip at 90 °) , (±1 °) | | | | |
| Tilt Speed | Configurable, from 0.5 %~ 80 %s, Preset speed: 80 %s | | | | |
| Pan/Tilt intervals | Default 300seconds, min 120seconds, max 3600 seconds. Customized per request | | | | |
| Proportional Zoom | Yes | | | | |
| Preset | 360 | | | | |
| Cruise | 8 cruises, up to 16 presets for each cruises | | | | |
| Trace | N/A | | | | |
| Power off memory | Support | | | | |
| Action mode | Preset/Cruise(No trace or scan) | | | | |
| 3D Positioning | Support | | | | |
| PTZ Position Display | Support | | | | |
| Schedule Task | Preset/Cruise/Dome reboot | | | | |
| Supplement Light | | | | | |
| IR Distance | Up to 20m, 4pcs 850nm | | | | |
| Smart IR | Yes | | | | |
| Network | | | | | |
| Main stream | 25fps:(2688×1520, 2560×1440, 2048×1536, 1920×1080, 1280×960, 1280×720); 30fps:(2688×1520, 2560×1440, 2048×1536, 1920×1080, 1280×960, 1280×720) | | | | |
| Sub stream | 25fps (704 ×576, 640 ×480, 352 ×288); 30fps (704 ×480, 640 ×480, 352 ×240) | | | | |
| Third Stream | 25fps (1920 ×1080, 1280 ×960, 1280 ×720, 704 ×576, 640 ×480, 352 ×288) 30fps (1920 ×1080, 1280 ×960, 1280 ×720, 704 ×480, 640 ×480, 352 ×240) | | | | |

| | |
|---------------------------|---|
| Video compression | Smart H.265+/H.265/H.264+/H.264/MJPEG |
| H.264 Encoder | H.264/AVC codec BP/MP/HP, level 5.1 |
| H.265 Encoder | H.265/HEVC codec MP, level 5.0 |
| Video bit rate | H.264: 128kbps~16,384 kbps; H.265: 51 kbps~12,288kbps |
| Audio Compression | G.711 A/U |
| Audio bit rate | 64Kbps |
| Protocols | HTTP, HTTPS, IPv4/IPv6, 802.1x, QoS, FTP, SMTP, UPnP, SNMP,DNS, DDNS, NTP, RTSP, RTCP, RTP, TCP/IP, UDP, IGMP, ICMP, DHCP, PPPoE, P2P |
| User / Host | Up to 16 users, 3 levels: Administrator, Advanced User and Normal User |
| Security Measures | User authentication (ID and PW), Host authentication (MAC address); HTTPS encryption, IEEE802.1x port-based network access control; IP address filtering |
| API | ONVIF G/S/T, support TVT SDK and third-party management platform |
| Client | TVT N9000 1.4.7, TVT NVMS 2.0; and the third-party client, free iOS and Android App |
| Web Browser | IE8-11 with plug-in; Edge, Chrome, Firefox with plugin free |
| Smart Features | |
| Basic event | Motion detection, video tampering alarm, exception (network disconnected, IP address conflict, SD full, SD error) |
| Face recognize | (Default off) human face detection, capture and face comparison. |
| Road traffic | Vehicle detecting and tracking, etc. |
| Smart Detection | Tripwire, Bi-directional tripwire, Illegal intrusion detection, Region entrance detection, Region exiting detection, etc. More VCA per request. |
| Smart Tracking | Smart tracking of human or vehicle, auto/manual |
| System Integration | |
| Audio Interface | 1CH audio input, 2 to 2.4v[p-p] 1KΩ ±10%,bare Wire; 1CH audio output (line out), impedance: 600Ω,bare wire |
| Built-in mic | 1-ch mic |
| Built-in Speaker | N/A |
| Audio device switch | Default use built-in MIC, manually switch to external |
| Alarm interface | 1CH alarm input(DRY Connection); 1CH alarm output |
| Alarm Linkage | Alarm actions, such as Preset, Cruise, Memory Card Video Record, Trigger Recording, Notify Surveillance Center, Upload to FTP/Memory Card, Send Email, etc. |
| Network Interface | 1 RJ45 10M/100M Adaptive Ethernet (Support PoE) |
| Storage Slot | Card chamber, support microSD/TF card, up to 256GB |
| Serial interface | No RS485/RS232 |
| Auxiliary video | N/A |
| Reset button | Yes |
| Heat and Fan | N/A |
| Water removal | Dust and Water-resistant coating for dome cover |
| General | |
| Languages | Czech; English, German; Hungarian ; Italian ; Japanese ; Korean ; Portuguese, Polish; Russian, Romanian, Spanish; Spanish(Mexico); Simplified Chinese; Turkish; Traditional Chinese. etc. |
| Power | DC12V ±20% 2000mA or PoE(802.3.af). avg 7Watt;max 12Watt (IR + PTZ working) |
| Working condition | -30 °C ~ 60 °C (-22 °F ~ 140 °F) IR off, -30°C ~ 40°C IR on; Cold start≥- 20°C(1Hour waiting), ≤90%RH |
| Storage condition | -40°C ~ 60°C ; ≤ 95% RH |
| Protection | 6000V Lightning Protection, Surge Protection and Voltage Transient Protection |
| Shield Material | Main body: Aluminum Alloy(ADC12); Bubble: Polycarbonate |
| Dim& Net weights | ∅ 116mm x 75mmH (∅ 4.56'x 2.95'), Approx. 463g(1 lb.) |
| Certification | IP67,IK10(include lens bubble), ROHS,CE,FC,UKCA,KC,BIS |



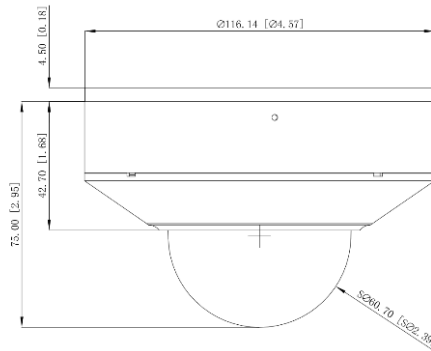

Ordering information

| | |
|------------------------|---|
| TD-8140IEN(PE/03M/AR2) | 1.8inch 4MP 3x zoom Network AI IR Dome PTZ camera, with flash mount adaptor. Support DC12V/PoE, IP67/IK10, not include power adaptor |
|------------------------|---|

Dimension(mm/inch):



Mounting Options:

| TD-YZJ1102(included) | TD-YZJ0209 | TD-YZJ0209+TD-YZJ0601 | TD-YZJ0209+TD-YZJ0502 | TD-YZJ0814 |
|---|---|---|--|---|
| In-ceiling mounting | Wall-mounting | Corner mounting | Pole-mounting | Pendant mounting |
|  |  |  |  |  |

Accessories:

Included :



TD-YZJ1102

Fast mount adaptor (also hook other brackets)

Optional:



TD-YZJ0209
Wall-mounting bracket



TD-YZJ0209+YZJ0601
Corner mounting bracket



TD-YZJ0209+YZJ0502
Pole mounting bracket



TD-YZJ0814
Pendant mounting bracket



TD-YZJ0211
Wall-mounting bracket
with junction-box



TD-YZJ0211+YZJ0601
Corner mounting bracket
with junction-box



TD-YZJ0211+YZJ0501
Pole mounting bracket
with junction-box



TD-YXH0101B
Junction box



DC12V2000mA
Power adaptor



TD-K22
PTZ Network Joystick & Keyboard



TD-K23
PTZ Network Joystick & Keyboard

*All texts, pictures and data subject to change without notice

Shenzhen TVT Digital TECHNOLOGY CO.,LTD

Address: 23rd Floor, Block B4, Building No.9, Shenzhen Bay, Eco-Technology Park, Nanshan District, Shenzhen, Guangdong Province, P.R.China

Tel: +86-755-36995888 Web site: <http://en.tvt.net.cn> Fax: +86-755-33104777 E-mail: overseas@tvt.net.cn